

# E1000

## Exposed Fastener Attachment System

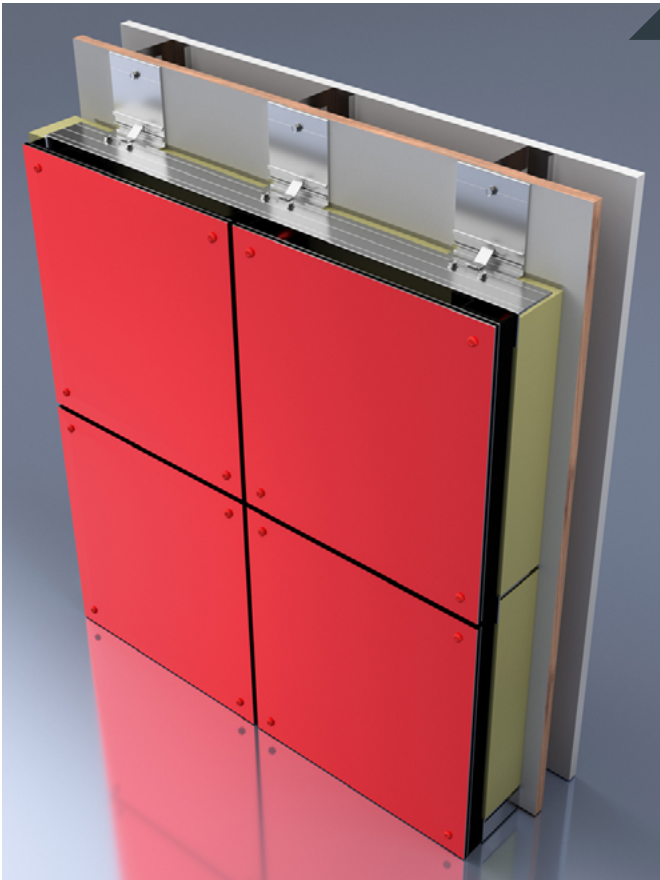

### Exposed Fastener Attachment System

CEI Materials E1000 Exposed Fastener Attachment Systems are cost effective yet still offer an architecturally attractive look.

#### System Characteristics:

- Drained Back Ventilated Rainscreen
- Easily Installed
- Low Maintenance
- Economical
- Available With HPL, MCM or Aluminum Plate

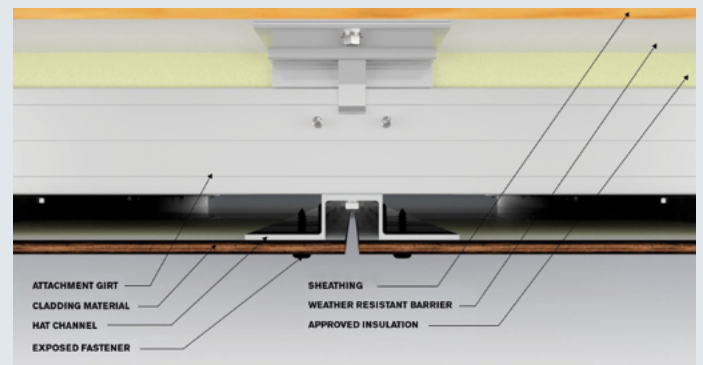

# E1000

## Exposed Fastener Attachment System

### TECHNICAL DETAILS

#### Face Material:

- MCM
- HPL
- Aluminum Plate Alloy 3030 & 5052

#### System Depth:

- MCM: 1 <sup>3</sup>/<sub>16</sub>"
- HPL: 1 <sup>5</sup>/<sub>16</sub>"
- Plate: 1 <sup>1</sup>/<sub>8</sub>"

#### Panel Extrusions:

- Aluminum Alloy: 6063-T6
- Mill Finish or Black Anodized Hat & J Channel

#### Fabricated Panel Tolerance:

**Length:** Plus 1.6mm (0.062in)

**Width:** Plus 1.6mm (0.062in)

**Depth:** Plus or minus 0.2mm (0.008in)

**Squareness:** 5mm (0.2in) maximum

**Panel Bow:** 0.8 percent maximum of panel length or width

#### Tested Systems & Code Compliance:

At CEI Materials we are dedicated to making sure that our cladding systems meet and exceed all the project specific requirements for performance and adherence to local & International Building Code standards. Depending on the system we will clearly identify what tests and procedures were completed internally and with third party assistance.

**ASTM E 283** - Static Air Infiltration

**ASTM E 330** - Structural Design loads (40psf)

**ASTM E 331** - Static Water Infiltration

**AAMA 501.1** - Dynamic Water Infiltration Test

**AAMA 509** - Drained & Back Ventilated Rainscreen Test

**NFPA 285** - Multi-Story Flame Spread Test

**Florida Product Approval**

#### System Details:

All system details at CEI Materials are available in Autocad & Revit.