

INOVEZE™

PLANK SYSTEMS



www.ceimaterials.com

INOVEZE

Plank Panel Systems

CEI Materials' **INOVEZE** rainscreen planking systems are an attractive, durable option for your exterior façade. Designed for fast installation, these prefinished planks are easy to clean and come with a 10-year product guarantee for longterm exterior performance. Inoveze planks can also be installed vertically or horizontally to achieve a cost effective innovative design solution.

Profiles

C-Plank Concealed Fastener Attachment System



SIZES:

Width: 6" Min – 24" Max in ½" increments

Length: 60" or 120"

Thickness: 8MM

System Depth: 5/8" (without subframing)

ORIENTATION:

Vertical or Horizontal

E-Plank Exposed Fastener Attachment System



SIZES:

Width: 6" Min – 24" Max in ½" increments

Length: 60" or 120"

Thickness: 8MM

System Depth: 1 3/8"

ORIENTATION:

Vertical or Horizontal

All system details at CEI Materials are available in AutoCAD® & Revit®.



INOVEZE

Attachment Accessories

C-Plank

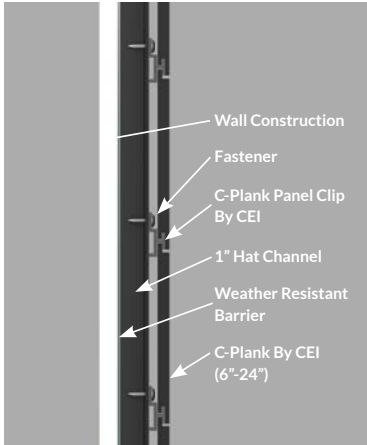

3" C-Plank Panel Clip
(.75 clips per ft²)

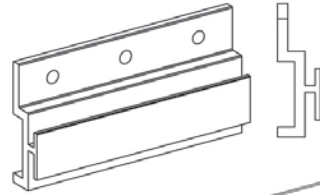

12' 0" C-Plank Starter

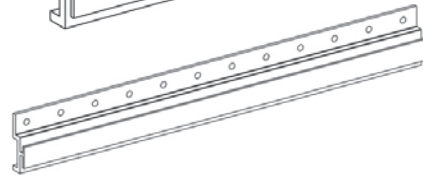

SFS SX3 - D10

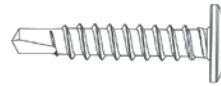

E-Plank

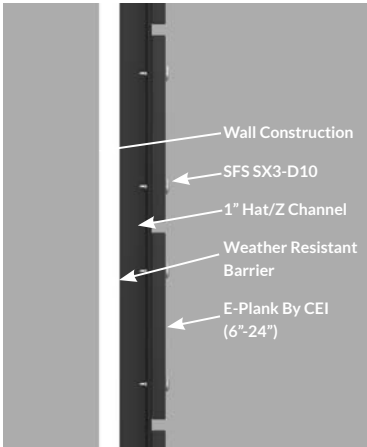

1" Z-Channel



1" H-Channel



Perforated Aluminum Angle

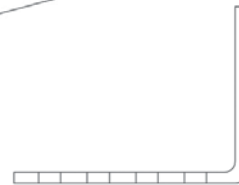

Color Options



NW02 Elegant Oak



NW08 Italian Walnut



NW30 Tropical Ipe



NW04 Pacific Board



NW24 Greyed Cedar



NW17 Milano Grigio



NW22 Slate Wood



NW13 Country Wood



NW10 English Cherry



NW28 Halmstad



NW06 Montreux Amber



P03.4.0 Silver Grey



P05.5.0 Quartz Grey



P25.8.1 Anthracite Grey



P12.6.3 Wine Red



A12.3.7 Carmine Red



P05.0.0 Pure White

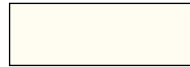

P03.0.0 White

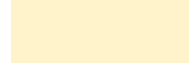

P04.0.2 Pale Yellow



P28.2.1 Aquamarine



800 E. Duncan Street, Manchester Michigan 48158 | 734.212.3006 | info@ceimaterials.com

© 2020 CEI Materials Inc. All Rights Reserved. INOVEZE™ is a trademark of CEI Materials Inc.

AutoCAD® and Revit® are registered trademarks of Autodesk, Inc.